

Assembly instruction

ACO leaf screen for all standard light shafts

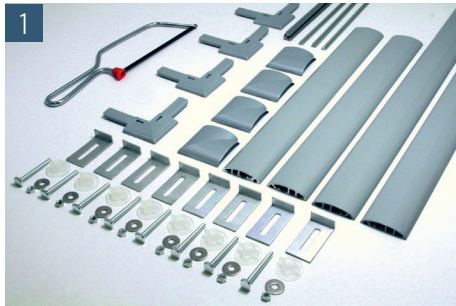

Check the package contents according to the illustration.

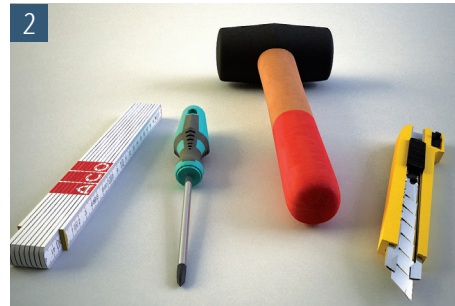

You should have the tool in the picture ready.

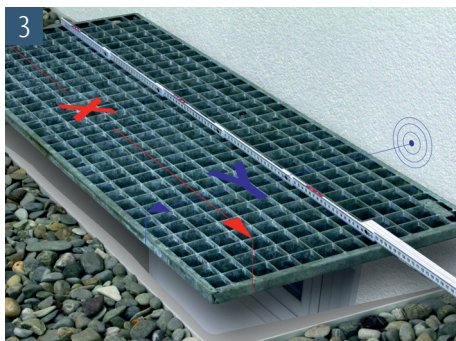

Determine the width of the grating (X dimension). Determine the depth of the grating and add the distance to the wall (Y dimension). Attention: It is essential to take any unevenness in the masonry into account.

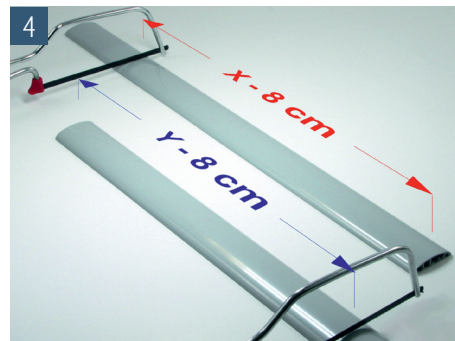

The two longer profile pieces are cut to the x-measurement minus 8 cm. The two shorter profile pieces are cut to Y-dimension minus 8 cm.

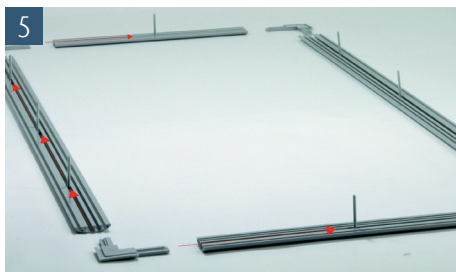

Lay out the cut profiles on a firm base. Before putting the profiles together, insert the hexagonal head screws into the profile groove provided.

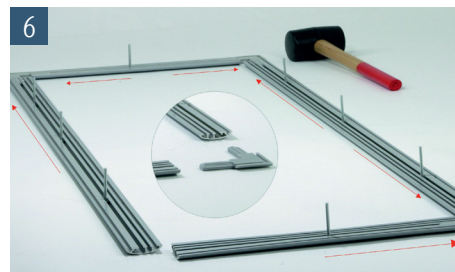

First assemble the frame on 3 sides by hand. Then fix it together with light taps. A rubber mallet is suitable for this.

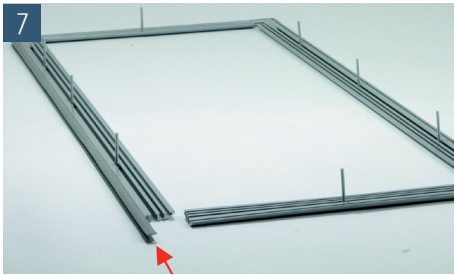

Shorten the rubber wall connection profile to the total length (X-measure grating). Then insert it into the groove provided: if you do not want a wall connection, this step is not necessary.

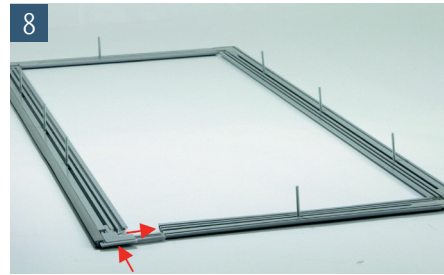

Now place the corner connector on the connection strip and fix the profile with light taps using a rubber mallet.

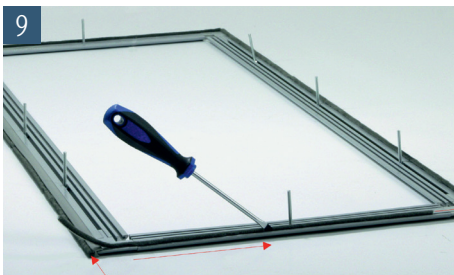

Cut the brush seals to the appropriate length. Press the brushes into the corner connector groove and slide them into the profile groove. Then push a piece of brush seal into the wall connection profile if necessary.



Align the fabric on the cover. Fix the fabric by using the impact keder as shown in the picture. Then cut the fabric around the keder.

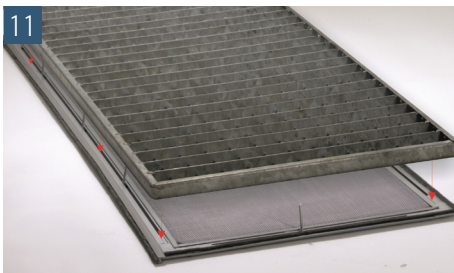

Now place the grating on the cover, aligning the pre-installed hexagonal screws.

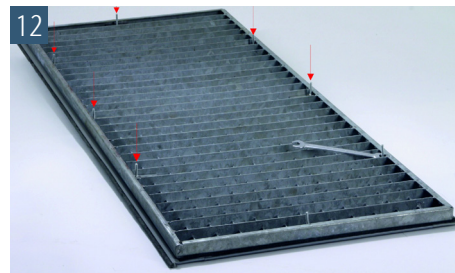

Depending on the type of grating, adjust the mounting brackets and fix them with the nuts. Then align the frame accurately and tighten the nuts.

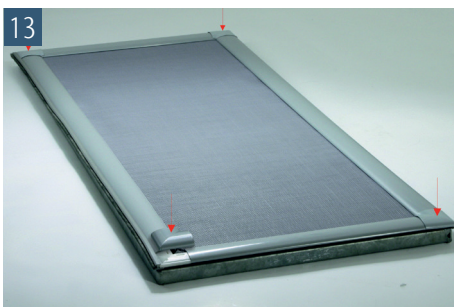

Fix the cover caps on the corner connectors and knock them on firmly. Finally, mount the grating on your light shaft as it was in its original state.

Your ACO leaf and insect screen is now complete.