

## Basement window

### Installation instructions for ACO Therm® 3.0 basement reveal windows in concrete walls

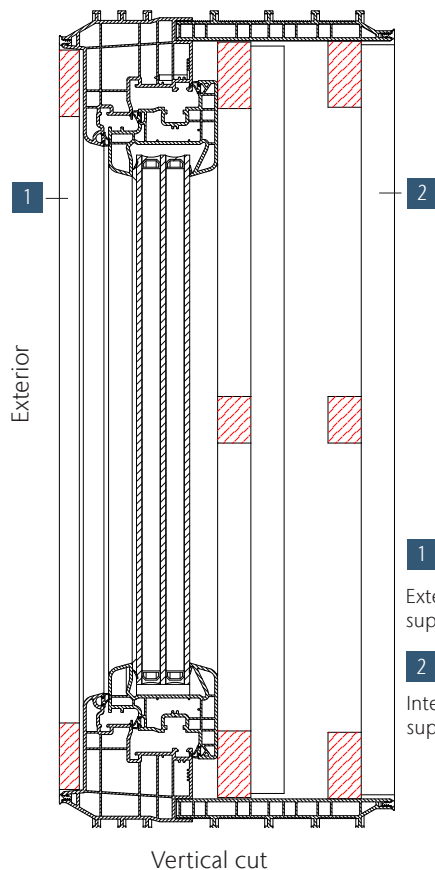

The window casement can remain in the frame. Depending on the construction depth, the support consists of at least two support frames.

A frame is provided for external support. This must be nailed to the formwork of the external wall on site.

The frames for the internal support remain in the basement reveal window to protect it from damage even after alignment.

The external dimensions of the frame correspond exactly to the clear internal dimensions of the frame. The basement reveal window is then placed on this frame.

The basement reveal window is prevented from slipping off by nailing the perforated sheet metal strips on the sides.

When concreting, make sure that the basement reveal window is fully embedded in the concrete. Air pockets, excessive compaction, and contact with the concrete vibrator must be avoided at all costs.

When stripping the formwork, care must be taken to ensure that the window frame is not damaged by the support frame attached to the wall formwork.



Recommended nail position for external fixing